

## DIMENSIONAL DRAWING OF THE BALL VALVE GF TYPE 546 WITH MOUNTING KITS

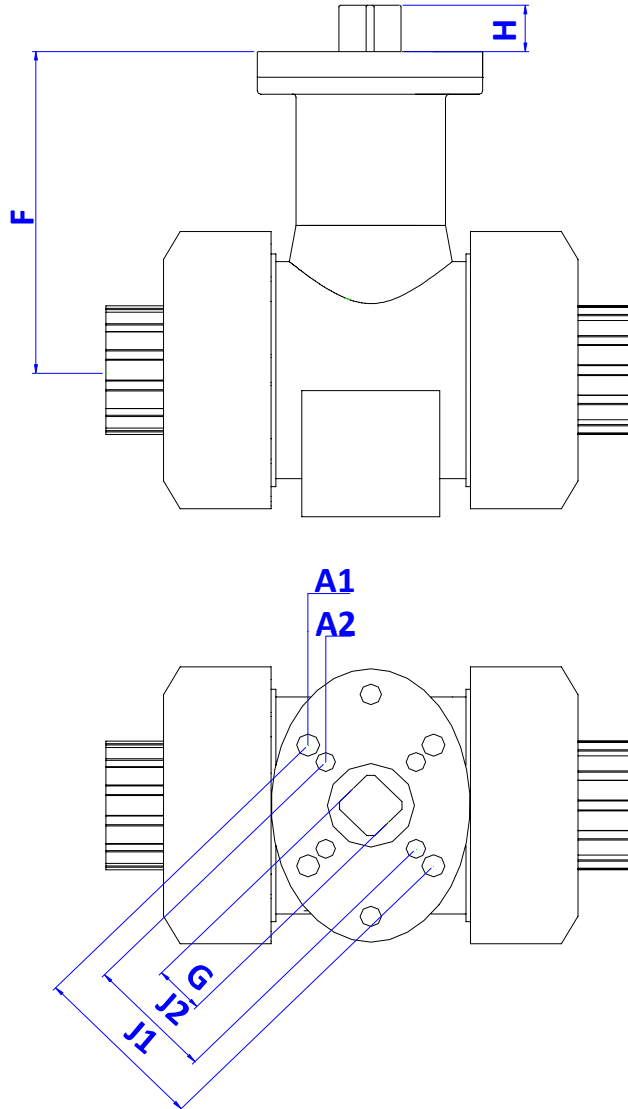

### DN15, DN20, DN25, DN32, DN40 AND DN50 VALVE

d	DN	F	G	H	A1	A2	J1	J2
16-20	10-15	47	□11	11	∅ 6,1	∅ 5,1	50 (F05)	36 (F03)
25	20	56	□11	11	∅ 6,1	∅ 5,1	50 (F05)	36 (F03)
32	25	67	□11	11	∅ 6,1	∅ 5,1	50 (F05)	36 (F03)
40	32	73	□11	11	∅ 6,1	∅ 5,1	50 (F05)	36 (F03)
50	40	80	□11	11	∅ 6,1	∅ 5,1	50 (F05)	36 (F03)
63	50	97	□11	11	∅ 6,1	∅ 5,1	50 (F05)	36 (F03)